

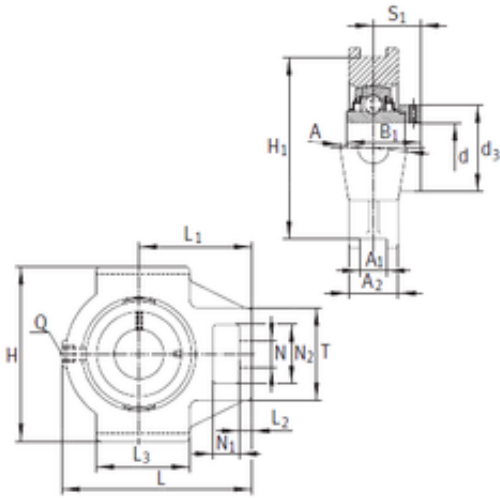

Osborn Load BEARING LTD

INA RTUE40 Take-Up Ball Bearing

Bearing No. RTUE40



RTUE40 Bearing 2D drawings and 3D CAD models

| | |
|-------------------------------|-----------------------|
| Bore Diameter | 40 mm |
| d | 40 mm |
| S1 | 35,1 mm |
| Thread (Q) | Rp1/8 |
| L2 | 16 mm |
| L3 | 82 mm |
| d3 | 58 mm |
| A | 50 mm |
| A1 | 16 mm |
| B1 | 56,5 mm |
| H | 115 mm |
| H1 | 102 mm |
| L | 141 mm |
| L1 | 88 mm |
| N | 29 mm |
| N1 | 20 mm |
| T | 82 mm |
| A2 | 35 mm |
| N2 | 49 mm |
| Weight | 2,52 Kg |
| Basic dynamic load rating (C) | 32,5 kN |
| Category | Take Up Unit Bearings |
| Inventory | 0.0 |
| Manufacturer Name | SCHAEFFLER GROUP |
| Minimum Buy Quantity | N/A |
| Weight / Kilogram | 2.52 |



Osborn Load BEARING LTD

| | |
|--------------------------|---|
| EAN | 4012802068818 |
| Product Group | M06110 |
| Component Description | Take Up Bearing Only |
| Rolling Element | Ball Bearing |
| Housing Style | Unit Only |
| Mounting Method | Eccentric Collar |
| Compatible Take Up Frame | Not Specified |
| Adjustment Travel Length | 0 |
| Insert Part Number | GE40KRRB |
| Housing Material | Cast Iron |
| Other Features | Single Row Spherical Double Land Riding Rubber Contact Seal |
| Inch - Metric | Metric |
| Long Description | Take Up Bearing Only; 40MM Bore; 16MM Slot Width; 102MM Slot to Slot Distance; Ball Bearing; Unit Only; Eccentric Collar Mount; GE40KRRB Insert Part; Cast Iron Housing Material |
| Category | Take Up Units |
| UNSPSC | 31171533 |
| Harmonized Tariff Code | 8483.20.40.40 |
| Noun | Bearing |
| Keyword String | Take Up |
| Manufacturer URL | http://www.ina.com |
| Weight / LBS | 5.557 |
| Slot Width | 0.63 Inch 16 Millimeter |
| Slot to Slot Distance | 4.016 Inch 102 Millimeter |
| Bore | 1.575 Inch 40 Millimeter |